

Weathermaster® Countrywoods® Shutters

Energy efficiency rating*

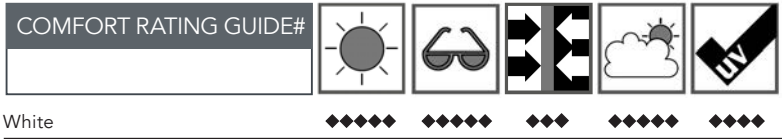

◆ No protection/performance, ◆◆ Low level of protection/performance, ◆◆◆ Medium level of protection/performance
◆◆◆◆ High level of protection/performance, ◆◆◆◆◆ Highest level of protection/performance

The comfort rating is designed to assist you in choosing the right window covering for each situation. Hunter Douglas Limited has developed the comfort rating with assistance from Canesis Pty Ltd – an independent Australian Fibre and Textile Research and Development Company.



Heat protection: refers to the ability of material to keep heat away.



Insulation: a high insulation rating is recommended where insulation is important for the comfort of the occupants and to reduce costs.



Shade factor: is defined as the level of shade that the blind provides in blocking out the direct sunlight.



Glare reduction: is defined as the reduction in the level of glare to provide optimum eye comfort.



UV protection: is defined as the level of UV light that is blocked out by the material.

Features and Benefits

Manufactured from renewable resource forestry

All timber used in the manufacturing process for Weathermaster timber shutters is sourced from sustainable forestry.

Timber is kiln dried to a low moisture content

Properly kiln-dried lumber is more stable minimising the risk of bowing and warping of profiles.

All panels are doweled and glued

Stronger construction which means that they will stand up to wear and tear. No visible screw holes, which means there are no unsightly marks to detract from the beauty of this natural product.

Superior paint finish

State of the art painting processes ensure a smooth and consistent finish over the entire shutter. The final coats of each shutter are sprayed after they are assembled, ensuring consistent colour across all profiles. The finish resists cracking, chipping & peeling under normal conditions, so your shutters will maintain their looks for years to come. Does not easily absorb stains and resists dirt or dust which makes cleaning your shutters a breeze.

Wide range of frame options

A variety of frames and mounting options are available, which are designed to meet the diverse range of consumer tastes and installation requirements.

Wide range of models (hinged, bi-fold, sliding)

The ability to cover most window applications, which can create a uniform look throughout the house.

Large range of paint and stain colour options

Choice of 5 paint and 10 stain options, allows you to choose a colour to complement and enhance the look of any room.

2 louver styles

Choice of traditional elliptical louver or flat louver to suit your décor.

64mm, 89mm & 114mm louver options

Allows you to choose a louver size to suit the style of window, or give the amount of view-through required.

Energy efficiency

Timber shutters not only add beauty to the home, they also improve the energy efficiency and reduce outside noise.

Weathermaster Countrywoods Shutters are covered by a three (3) year warranty. Conditions apply.

Weathermaster®

Outdoor / Shutters / Countrywoods® Shutters



Countrywoods® Shutters

Top-quality, custom-made timber shutters that accentuate your home.

Weathermaster®



Weathermaster® Countrywoods® Shutters

Weathermaster Countrywoods Shutters provide the timeless beauty and enduring craftsmanship of real timber, custom made for your home.

Weathermaster Countrywoods Shutters are a beautiful combination of functionality, durability and practicality in a window covering. They are more than just a basic window covering; providing light and heat control, whilst adding style and value to your home. Each shutter is custom made to your window or doors exact specifications.

Weathermaster Countrywoods Shutters are manufactured from premium quality kiln dried timber that is light, strong and extremely stable. Louvers and profiles are carefully prepared and undergo an exacting process to ensure a fine lustrous and durable finish.

Weathermaster Countrywoods Shutters feature a modern colour palette including 5 standard paint finishes and 10 stains to compliment any interior colour scheme.

Frame and Mounting Options

With a variety of frame style and mounting options, including hinged, bi-fold on track and sliding on track, there is a shutter system available to suit almost any window or door application.



Standard hinged

The standard hinged option is suitable for small to medium window widths, and can consist of one or more rectangular shutter panels hinged in a variety of configurations.



Hinged bi-fold & bi-fold on track

There are two bi-fold styles depending on the widths and heights of the window. The first option uses the same frame configurations as the standard hinged style, with one panel bi-folding off another. For larger applications, bi-fold on track options are available.



Sliding on track

Sliding applications require the use of a top track and either bottom guides or a bottom track. The panels do not open or bi-fold, but rather slide left to right on either one or two tracks. The sliding system allows you to cover wide widths, and is a wonderful way to treat sliding doors to match the rest of your windows.

Tilt Bar Options



Front Tilt

The standard front tilt system provides the traditional look of plantation shutters & features a stylish tilt bar connector that allows quiet closure. The tilt bar can be mounted in the middle of the shutter panel, or to the side depending upon taste.



ClearView hidden tilt mechanism

The ClearView hidden tilt mechanism delivers a clean contemporary look, with an unobstructed view through the open louvres.

The hidden tilt bar protrudes to the rear of the louvre by 5mm when the louvre is open. Hidden tilt bars are placed on the hinged side of a panel unless otherwise specified.

* Rear of Panel Shown

Panel Closure

Default is right panel closing on left panel.

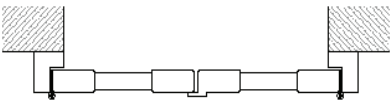

Safety Information

Child safety is an important consideration of all Weathermaster products. Because there are no dangling cords or cord loops and the paint and stain used to finish the shutters are non toxic, Weathermaster Countrywoods Shutters are a child safe window covering.



Louvre Size Options

Weathermaster Countrywoods Shutters are available in 3 louvre sizes depending on the level of view through required.

The elliptical shaped louvre is available in 64mm, 89mm and 114mm (as shown below).



64mm louvre open



89mm louvre open



114mm louvre open

